

FORM No. 1.

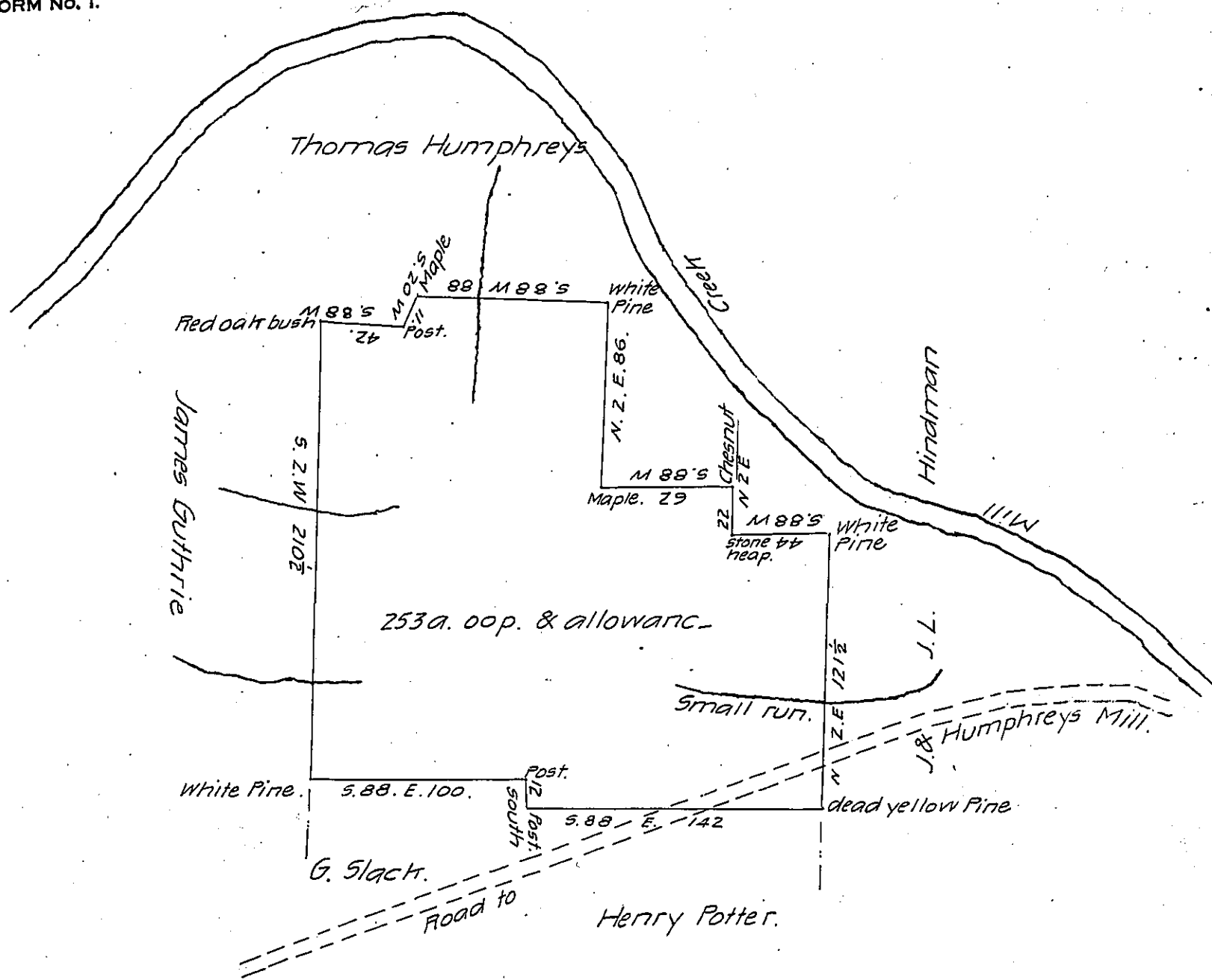

Draft of a tract of land situate in Clarion Township Clarion County South of Clarion River and East of Mill Creek Survey'd for John Taylor Dem 2nd 1847. Containing two hundred and fifty three acres and allowanc- of six per Ct in pursuance of a warrant dated Sept 27th 1847.

Sidle Lobough S.D.S.

To John Laporte S.G.

IN TESTIMONY that the above is a copy of the original remaining on file in the Department of Internal Affairs of Pennsylvania, made conformably to an Act of Assembly approved the 16th day of February 1833, I have hereunto set my hand and caused the Seal of said Department to be affixed at Harrisburg, this twelfth day of April 1907

Seaton B. Brown
Secretary of Internal Affairs.